

# 15. SE-505

## SPECIFICATIONS

Speaker	Woofer-polyester cone 45 $\phi$ mm (1-3/4 in) Tweeter-polyester cone 32 $\phi$ mm (1-1/4 in)
Impedance	8 $\Omega$
Matching impedance	4 to 16 $\Omega$
Frequency response	20 to 20,000 Hz
Sound pressure level	108 dB/0.3V
Maximum input	500mW (each channel)
Cord length	Retractable coiled cord extensible up to 5m (16.4 feet), with 3-P plug
Weight	690g 1lb 8oz. less cord
Subfunction	Volume control Tone control



### NOTE:

Specifications and the design subject to possible modification without notice due to improvements.

## PARTS LIST

Key No.	Description	Part No.
1	Head pad with lead wire	SXC-082-0
2	Head band A	SNB-066-0
3	Name plate (Left)	SAL-271-0
4	Head band holder Assembly B	
5	Spring	SBH-001-0
6	Steel ball 4 $\phi$	SEF-022-0
7	Name plate (Right)	SAL-271-A
8	Head band B	SNB-067-0
9	Shaft	SXC-080-0
10	Band	SNB-065-0
11	Ear pad	SCD-441-0
12	Acoustic material	SMT-090-0
13	Tweeter assembly (Right)	SXC-085-0
14	Tweeter assembly (Left)	SXC-079-0
15	Acoustic material	
16	Woofer assembly	45-703F
17	Volume control assembly	SXC-083-0
18	Protection board (Right)	SNK-085-0
19	Protection board (Left)	SNK-084-0
20	Capactor 8 $\mu$ F 10V NP	
21	Acoustic material	
22	Case (Left)	SCC-232-0
23	Case (Right)	SCC-233-0
24	Knob (Tone control)	SAA-088-0
25	Knob washer	SEC-119-0

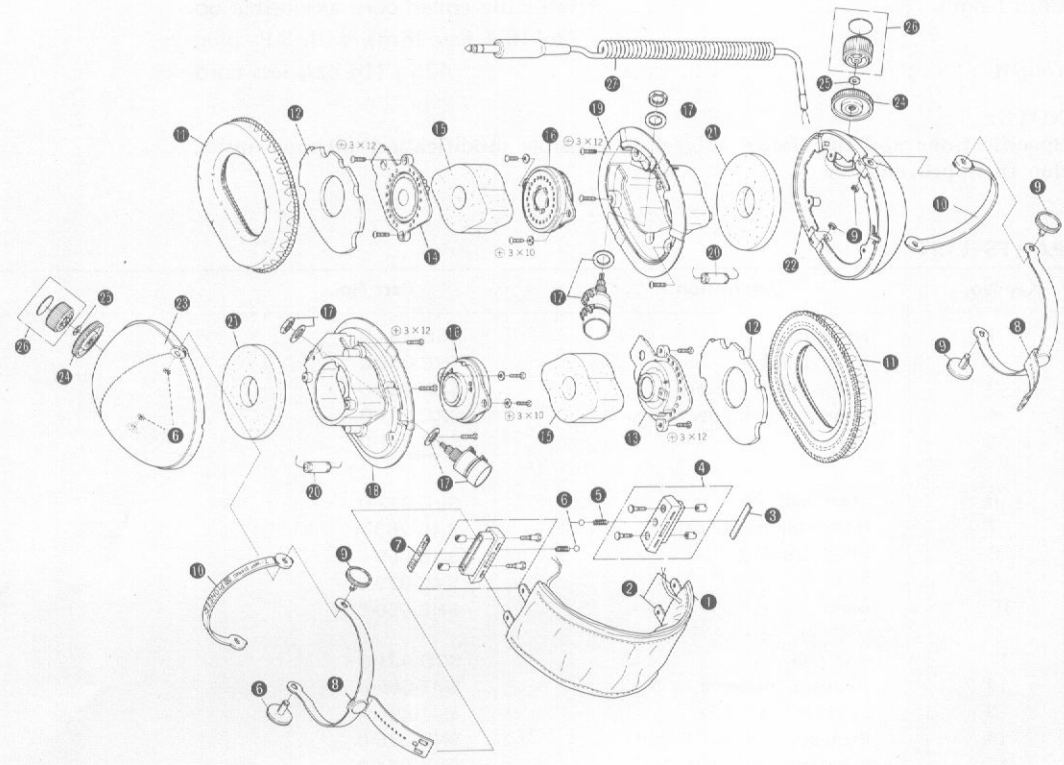

Key No.	Description	Part No.	
26	Knob assembly (Volume control)	SXC-084-0	
27	Coiled cord with 3-P plug	SXC-078-0	
	Operating guide	SRB-061-0	
	Plastic case	SXC-074-0	
	Packing case	SHG-052-0	